

## NEVER STOP WORKING

Introduce a CAS® Reloader into your fleet and you will see dramatic increases in equipment efficiency and productivity, with significant decreases in manpower and assets required to complete a job. The RL19 is specifically designed to keep conveyor belt trucks and trailer mounted blower machines constantly fed with a variety of material and virtually eliminate material waste.



10'  
**CLAMSHELL**  
Hopper

36"  
**IMPACT RESISTANT**  
Belt

Funnel  
**Dropout**  
Optional Attachment

LIQUID COOLED  
**TURBO DIESEL**  
Engine

YANMAR  
**CANplus® 600**  
Electronic Engine Controls

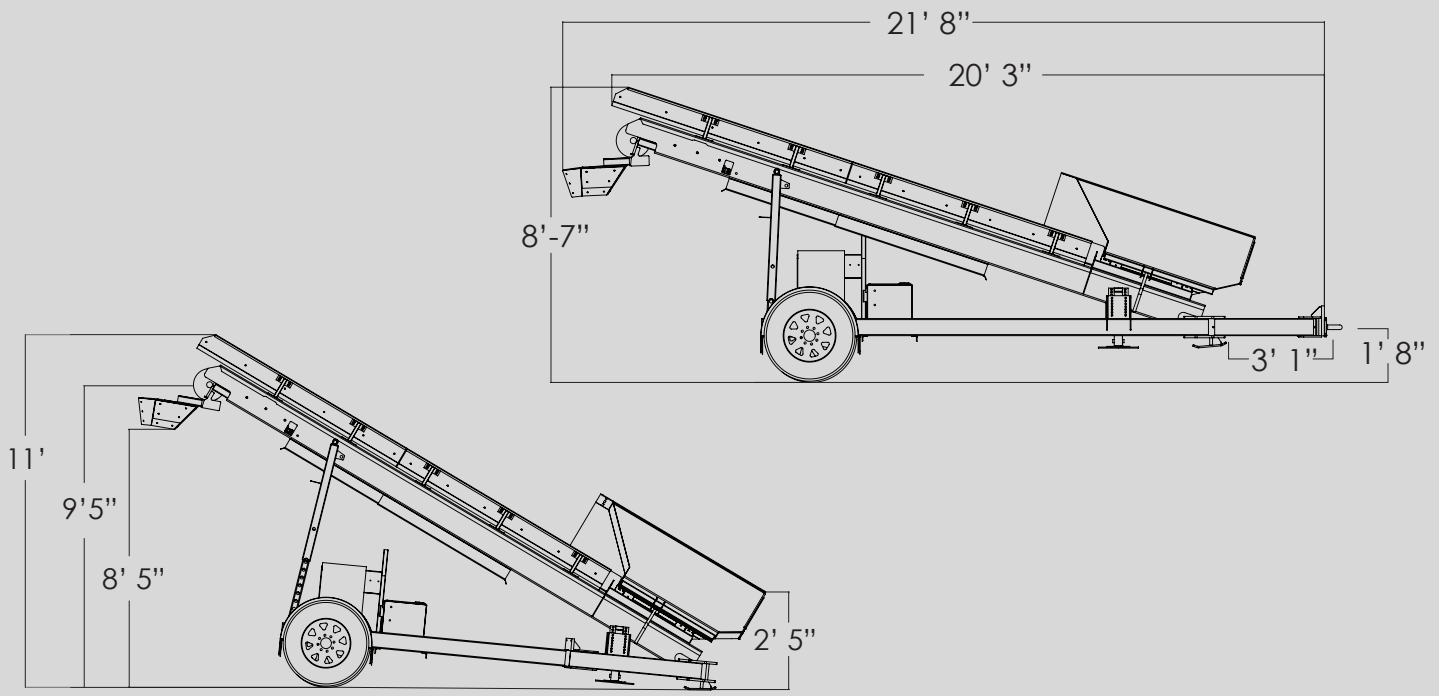

## RL19

### Chassis & Frame:

- Quality Heavy-Duty Steel Construction
- Powder Coated
- Built in the USA

### Engine:

- Engine - Yanmar® Final Tier IV and EU Stage V Compliant
- 4 Cylinder 47.6hp Diesel Engine

- Main Feed Belt
- Direct Hydraulic Drive

### Production:

- \*Volumes vary upon material
- 4-6 Tons of 1" Rock per Minute
- 6-10 Yards of Organic Material per Minute

### Steel Hopper:

- Heavy-Duty Steel Sheeting
- Fully Powder Coated
- 10' Wide Clamshell Hopper

### Feed Conveyor:

- Heavy-Duty Abrasive & Impact Resistant Belt
- 36" Cleated Feed Belt
- Hydraulically Powered
- Height Adjustable

### Weight & Dimensions:

\*Specifications may vary upon options/packages

- Tow Weight
- Approx. 7,000 lbs

- Tow Length
- 22'

- Operational Length
- 20'

- Tow Width
- 8' 6"

- Tow Height
- 8' 7"

- Operational Clearance Height
- 12'

### Electrical System

- 12 or 24 VDC
- Yanmar CANplus® Electronic Engine Controls

### Optional Equipment:

- Radio & Receiver Remote Controlled Package
- Funnel Dropout Attachment